

SHARJAH HEALTHCARE CITY STANDARD COMPONENTS

Room Layout Sheet

Room Name Clerical Support/ Medical Records

RLS Room Code CLREC-SJ
RDS Room Code CLREC-SJ

- AS

COM/2

GPO/2

LS/P

LS/R

OP

SK4

SK7

V1

WB
- ADJUSTABLE SHELF
COMMUNICATIONS OUTLET - DOUBLE
GENERAL POWER OUTLET - DOUBLE
LIGHT SWITCH - PELMET TASK LIGHT
LIGHT SWITCH - ROOM
OBSERVATION PANEL
FLOOR VINYL COVED SKIRTING
TIMBER SKIRTING
VINYL FLOORING, STANDARD SLIP RESISTANT
WHITEBOARD

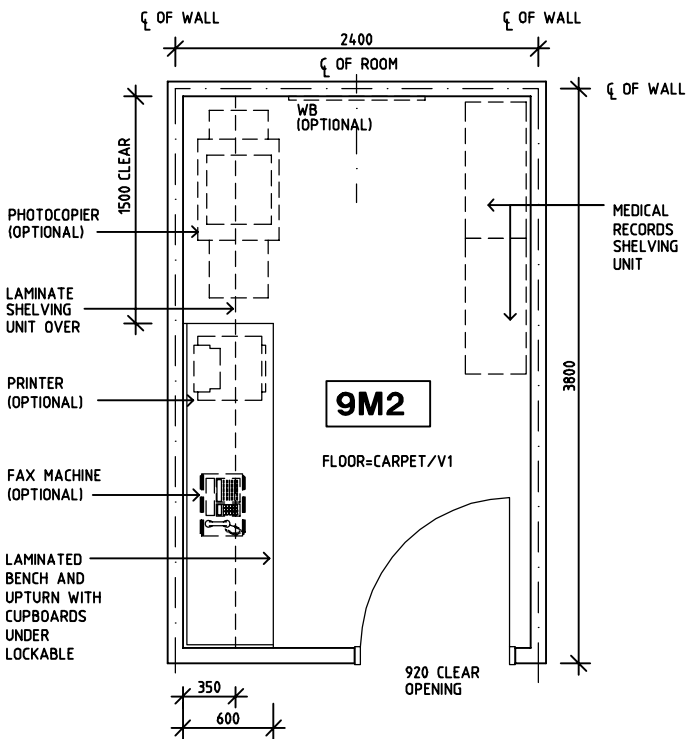

PLAN

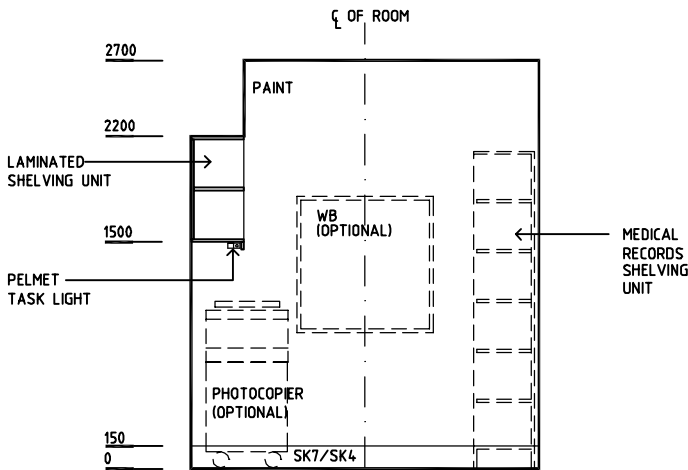

ELEVATION 1

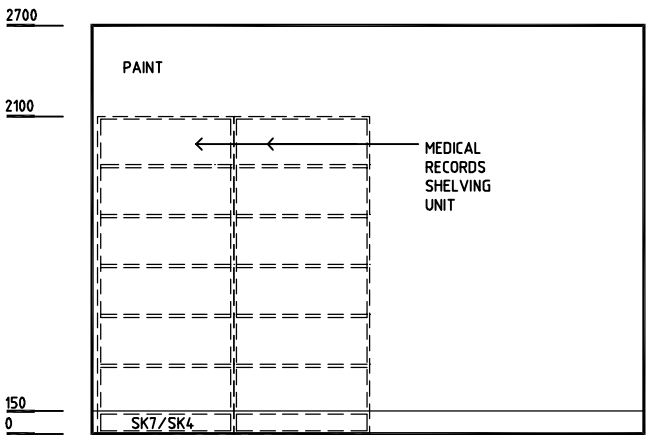

ELEVATION 2

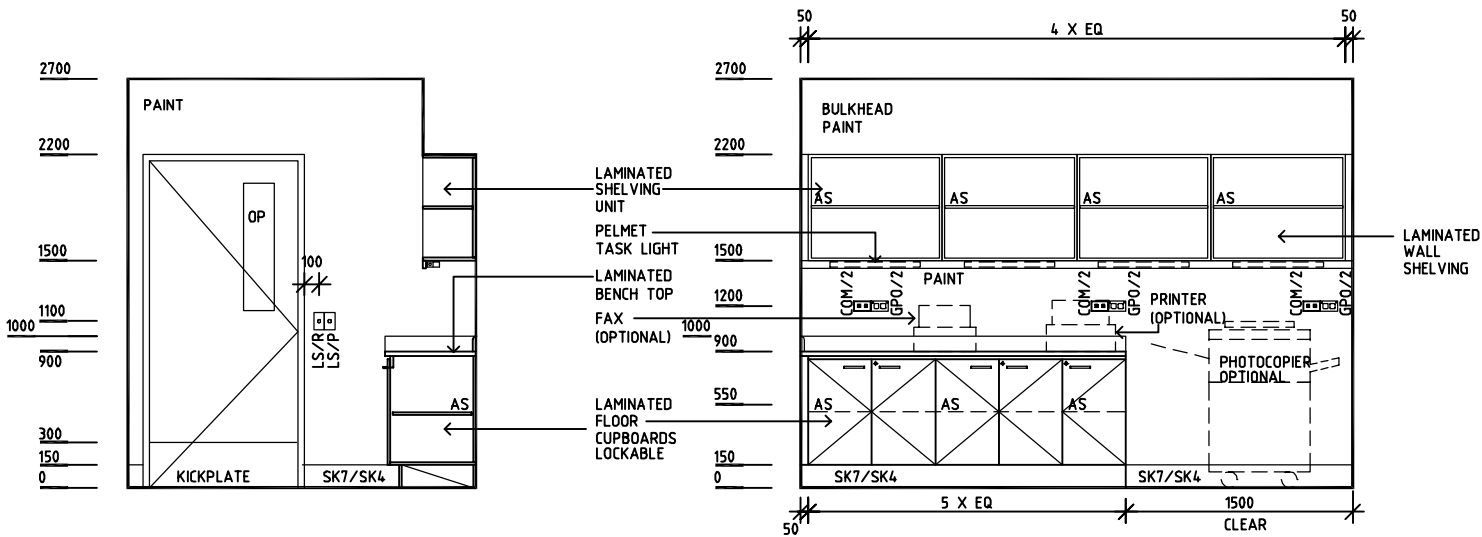

ELEVATION 3

ELEVATION 4

REV	DESCRIPTION	DATE	BY	REV	DESCRIPTION	DATE	BY	REV	DESCRIPTION	DATE	BY
1	FIRST ISSUE	14.03.2014	AA								

	<h1>SHCC Guidelines</h1>	<p>Sharjah Health Facility Guidelines at: www.healthdesign.com.au/shccfg Editable version of Standard Components on Health Facility Briefing System (HFBS) at: www.healthdesign.com.au Provided by TAHPI</p>	DESIGNED	APPROVED	DATE	SCALE(S)	SHEET
			CC	DB	30.12.13	1:50 in A3	1 of 1
			CAD FILE NAME CLREC-SJ		PAPER DRAWING ID CLREC-SJ		ISSUE 1